

CERVETTI



Cervetti 44

Introducing the new Cervetti 44 catamaran marks the new era of our shipyard aiming at quality over quantity.

Developed in the cooperation with the young team of Italian designers and engineers from yacht design studio Skyron, this catamaran combines all the characteristics one could wish from a boat.

Bold, dynamic design of the hulls with the inverted bows gives you the sensation of a constant movement while the signature grill on the deckhouse and sporty openings at the stern add even more dynamics to the overall impression.



On the flybridge

The spacious flybridge provides an oversized sunbathing area that is easy to access from the inside of the cockpit. Low lounge table and 36lt fridge integrated into the bench give extra comfort and convenience while enjoying time on the fly.

The helm station is positioned more forward leaving the lounge area to be enjoyed in maximum privacy.

The large console integrates all the navigational equipment in a very stylish way while winches, which are within reach, allow easy and simple maneuvering.

The whole flybridge area is covered with a wide bimini for maximum protection from the sun.



Inside the cockpit

The spacious cockpit area is the heart of the boat and is central place for gathering with friends or family. The various seating and relaxation areas can accommodate up to eight people. The plancha (barbecue) is integrated into the bench, allowing the chef to be part of the fun and not shut away inside..

Sliding doors and windows on the deckhouse connect the cockpit area with the galley and the saloon, enabling easy communication.

Openings on the cockpit floor provide plenty of storage space while engine and service areas are easily accessible through large engine room hatches.

Hydraulic platform, which comes as an option, serves as a dinghy lift or as a floating beach.

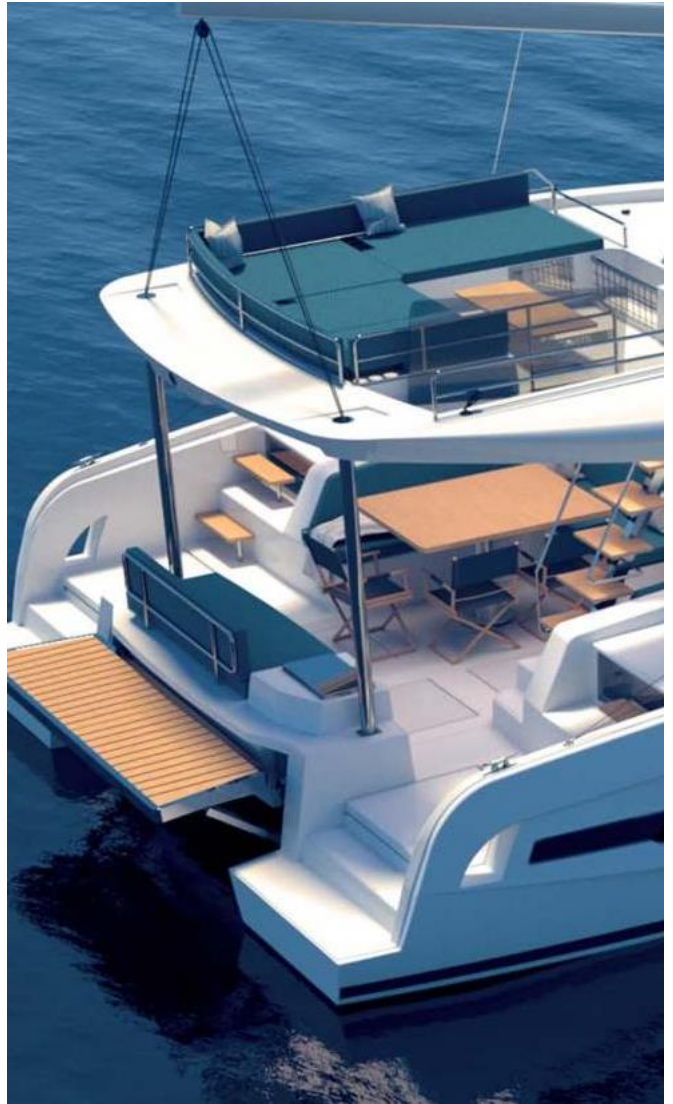



Saloon & Dinette

Due to the forward position of the mast there is no obstacle between the large L-shaped galley, sea-facing chart table and the saloon, making it an ideal and usable space.

There is a plenty of storage space and the galley is equipped with all the necessary appliances.

A sliding electric window on the deckhouse allows direct communication between the saloon, the galley and forward sunbathing area.

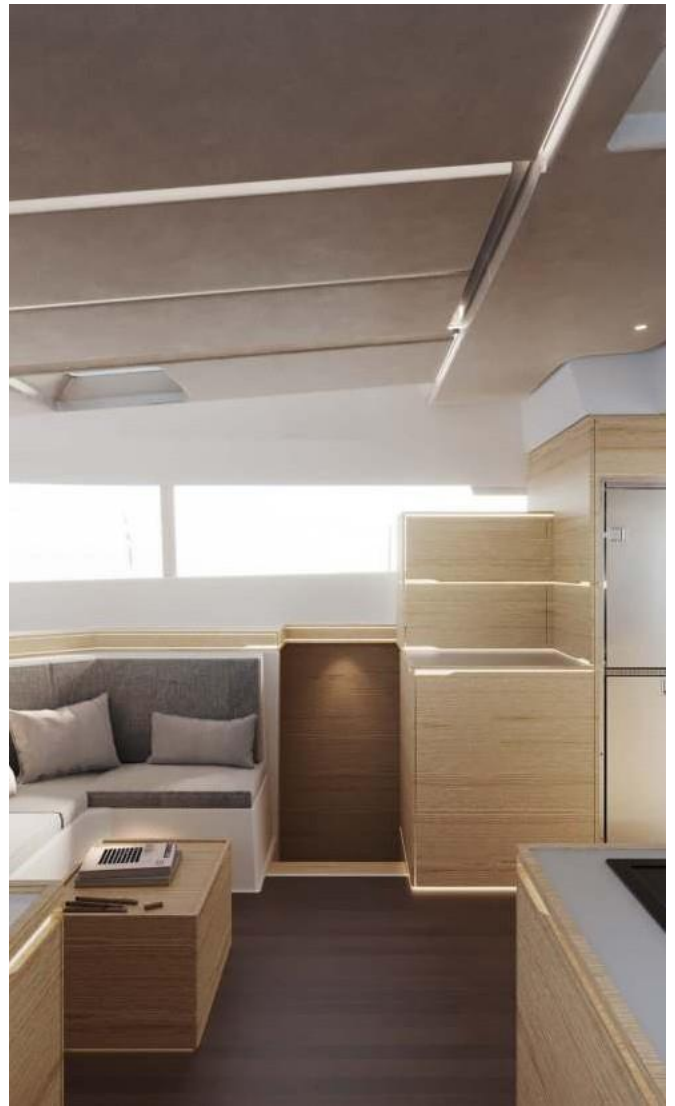





Comfortable cabins

All the cabins, in any configuration, are equipped with 200 cm x 160 cm beds and are extremely bright and ventilated thanks to the numerous porthole openings and windows.

Innovative and playful design of the furniture gives the feeling of much bigger and more open space while providing plenty of storage and closet space.

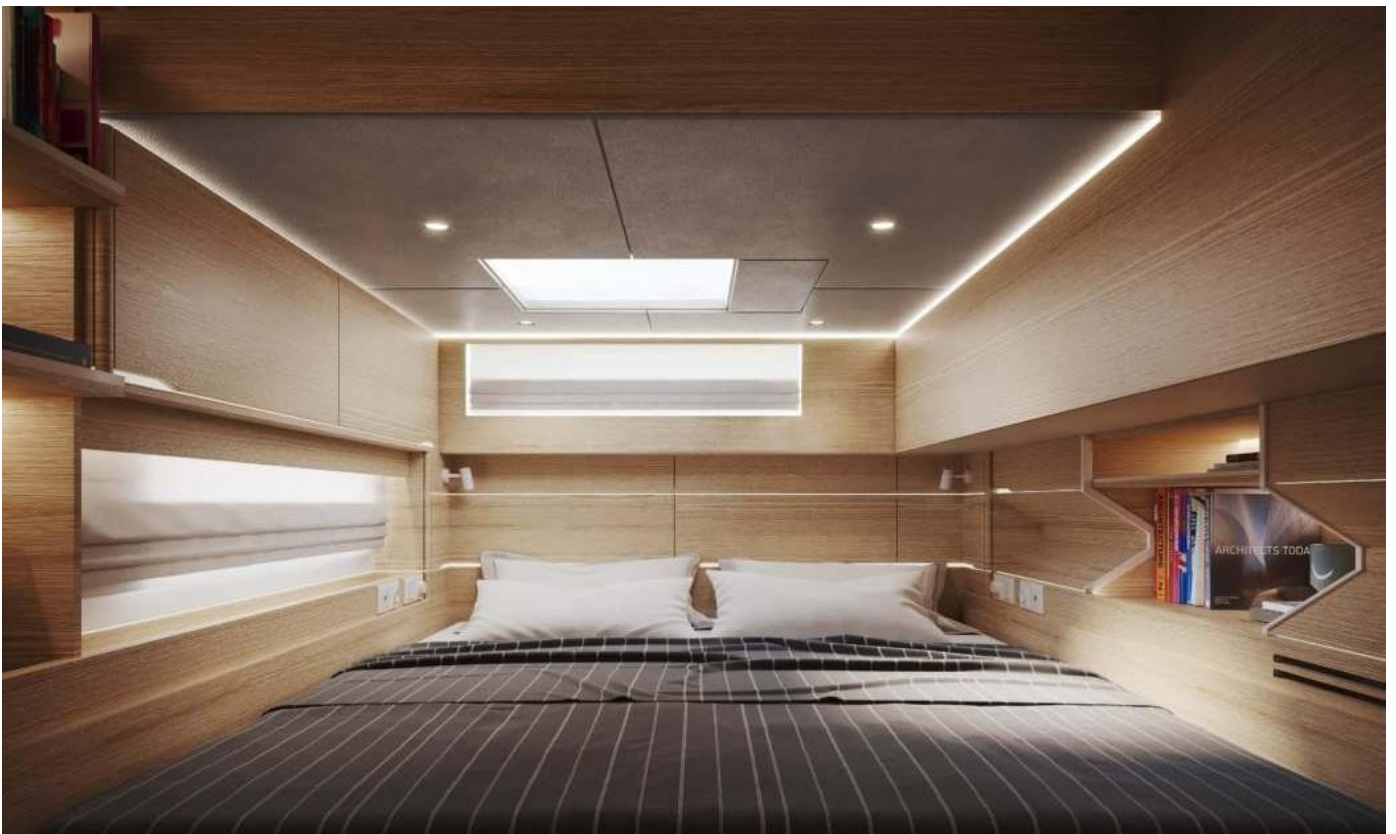



Flybridge

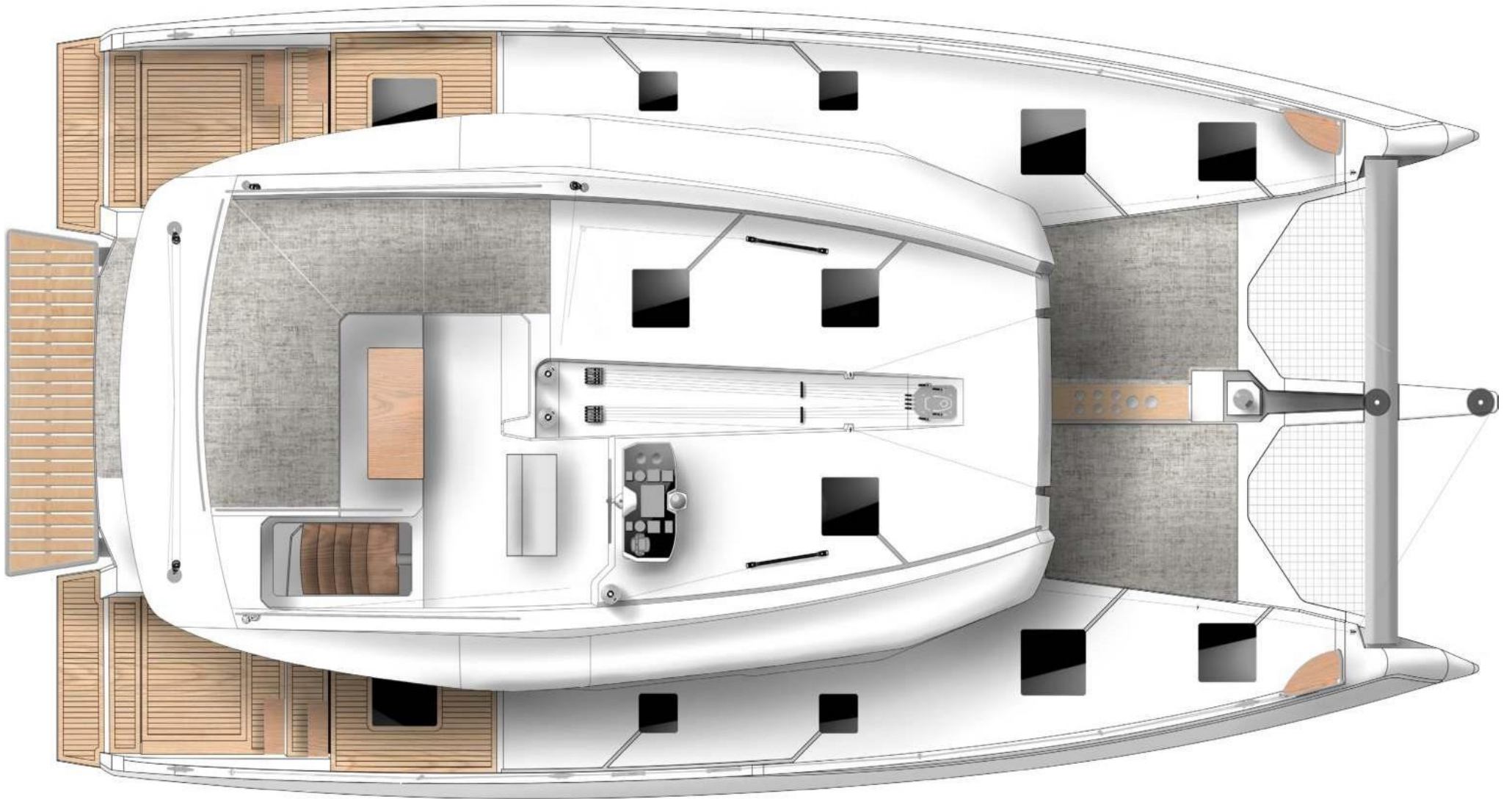

Main Deck

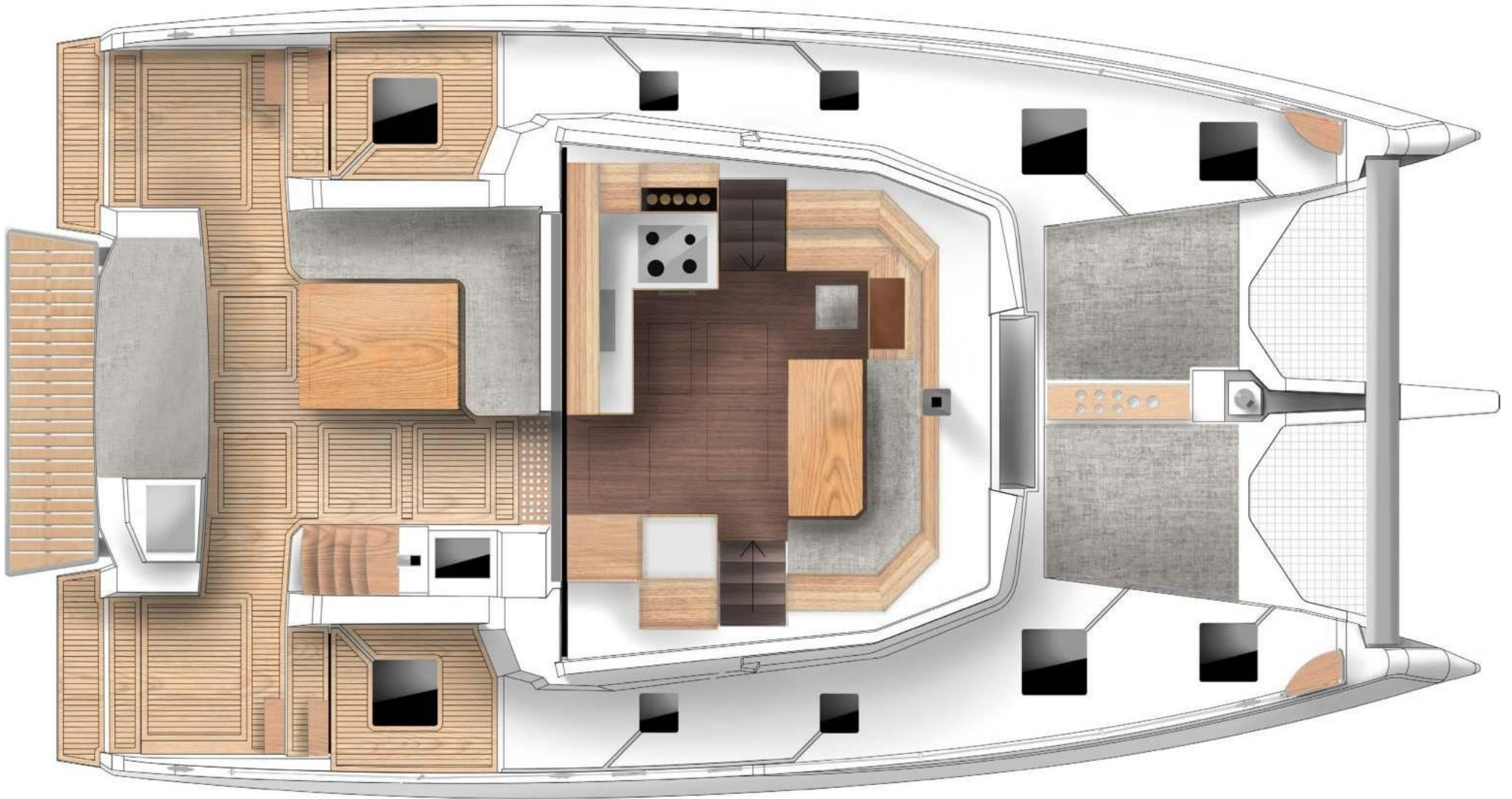

Layout A

- 4 double cabins / 4 toilettes
- Single skipper's cabin portside and toilette and shower starboard side

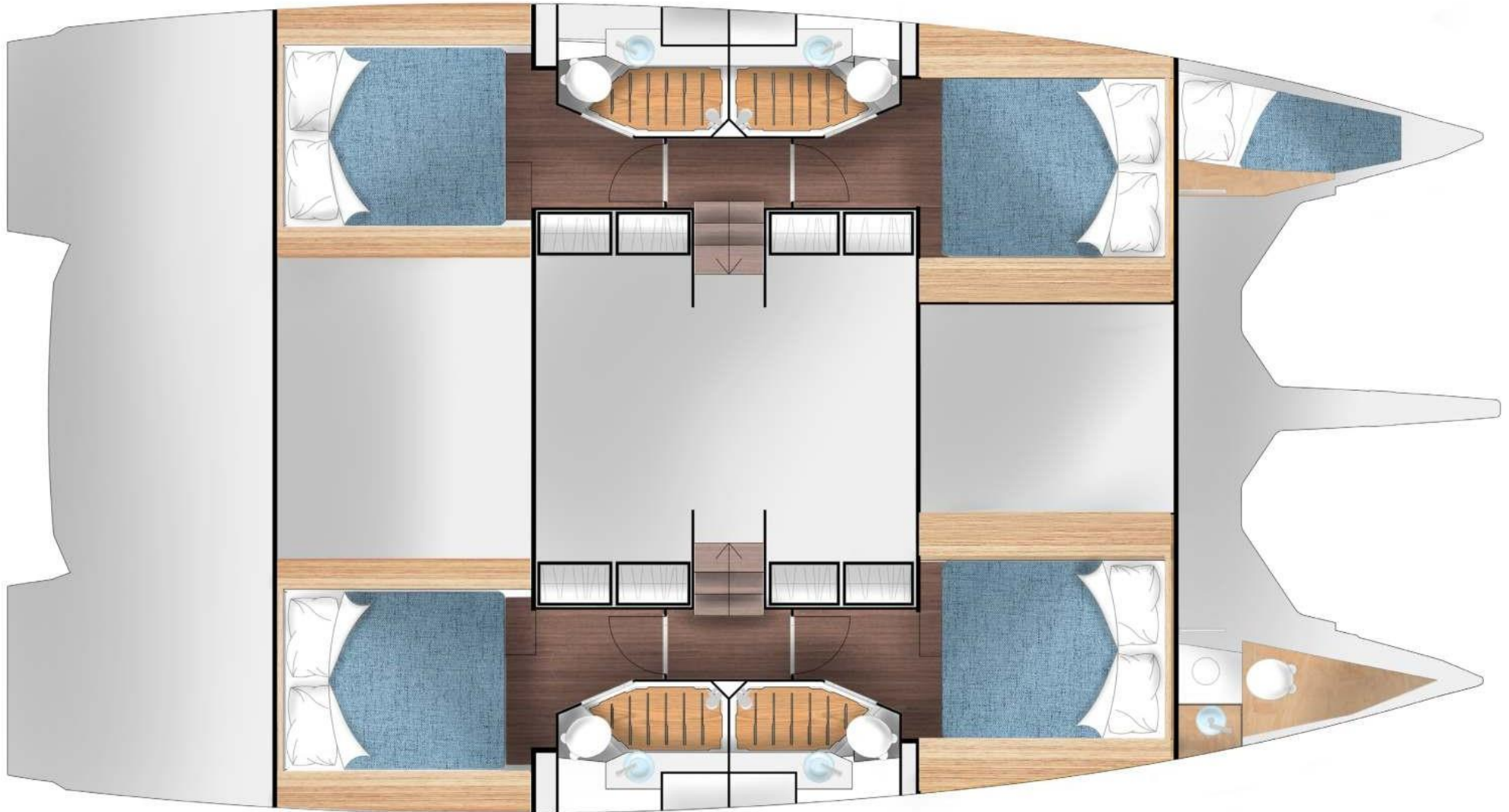

Layout B

- Owner's suite and ensuite bathroom starboard side
- 2 double cabins with bathrooms portside
- Single skipper's cabin portside and toilette and shower starboard

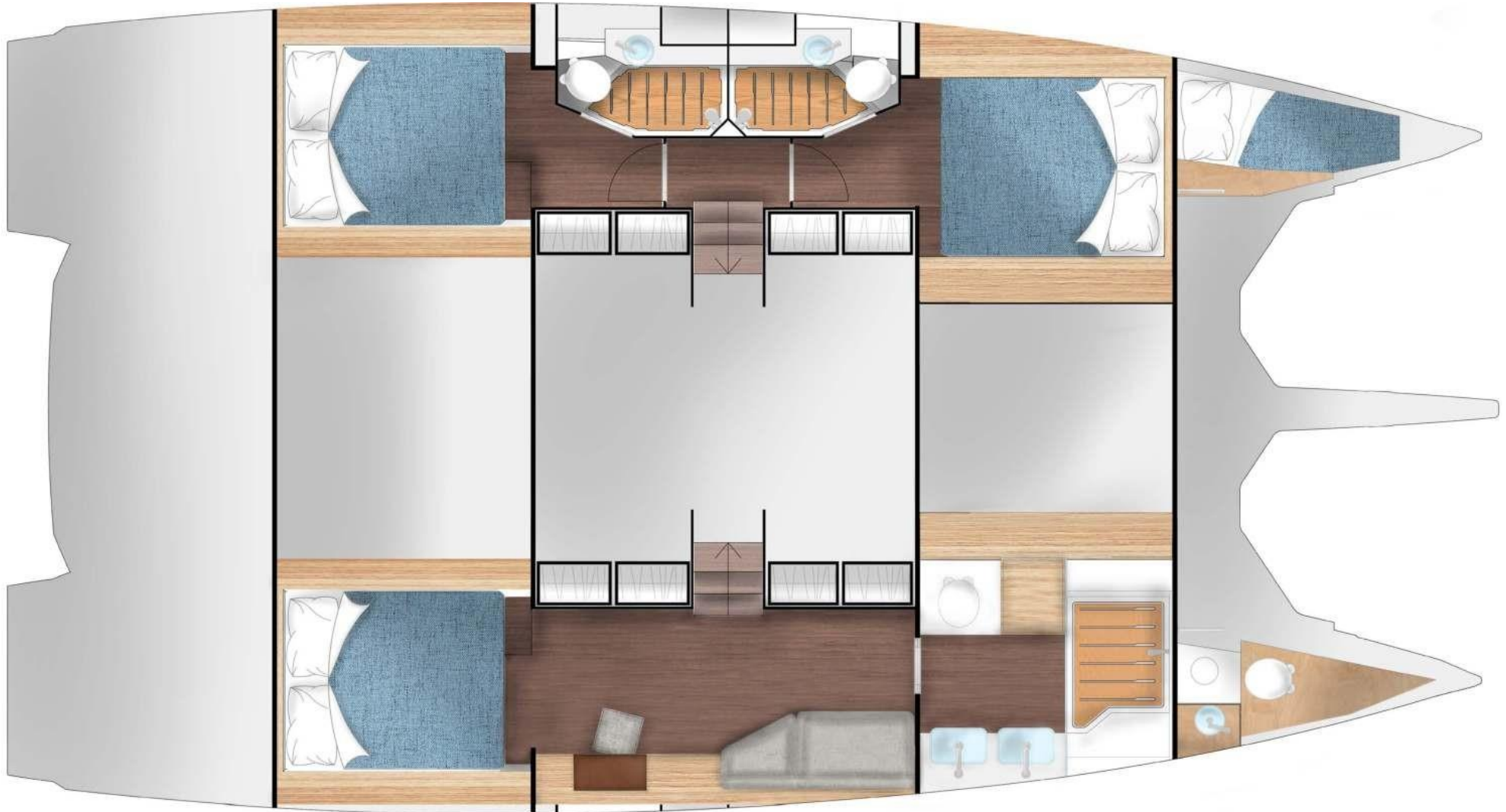

Technical Specification

Architect



L.O.A	13.42 m
-------	---------

B.O.A	7.30 m
-------	--------

Displacement	16,5 t
--------------	--------

Draft	1.30 m
-------	--------

Engine	2x VOLVO D2 diesel sail-drive 60 HP
--------	-------------------------------------

Guests	8-6 depending on the version
--------	------------------------------

Crew	1-2
------	-----

Cabins	4-3 depending on the version
--------	------------------------------

Bathrooms	4-3 depending on the version
-----------	------------------------------

Fresh water	2 x 450 l
-------------	-----------

Fuel	2 x 450 l
------	-----------

Up wind sail area	110 m ²
-------------------	--------------------

Sail Plan

Main sail	78 m ²
Jib	40 m ²
Gennaker	100 m ²
Code zero	85 m ²

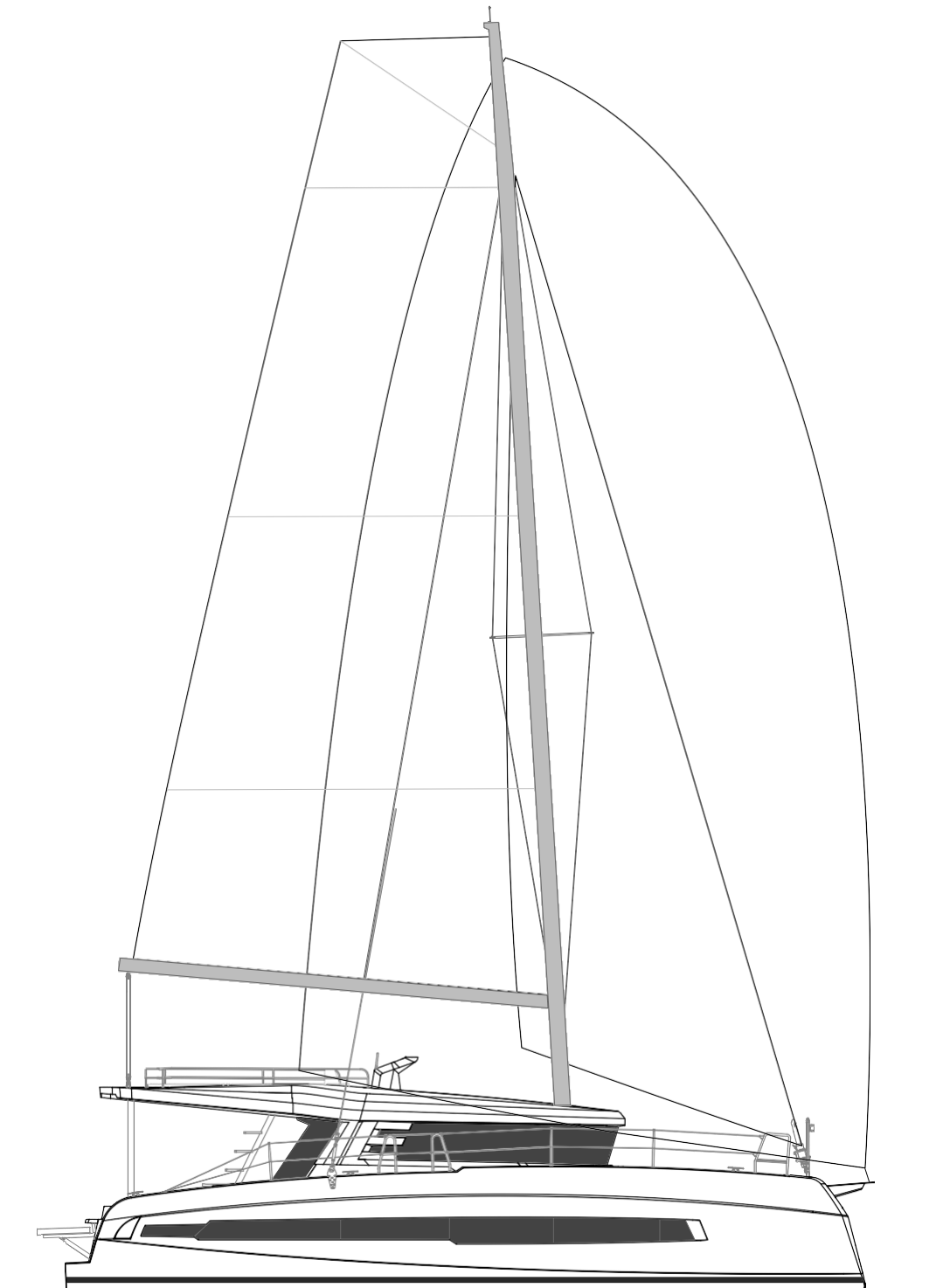

CERVETTI

CATAMARANS



Contacts

Headquarter Greece Office: 10 Amfitheas Ave,

Paleo Faliro, Athens 17562

Greece +30 (210) 220-1517

salesteam@synergyyachtsales.com